

PREMIUM LISTS

ENTRIES CLOSE WEDNESDAY NOON, MARCH 17, 2010

After which time entries cannot be accepted, cancelled, altered or substituted except as provided for in Chapter 11, Section 6 of the Dog Show Rules

Back to Back Shows!

All Breed Dog Shows, Obedience Trials & Rally Trials- Unbenched

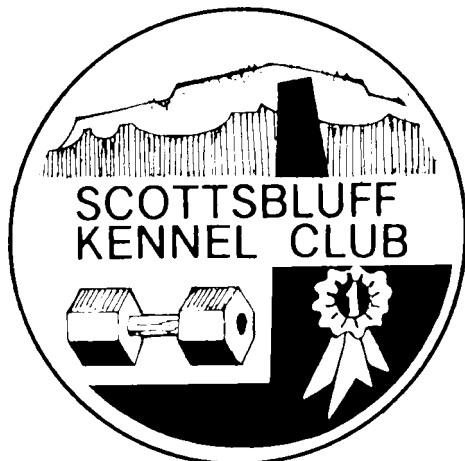

Licensed by the American Kennel Club

Conformation & Obedience - 2010172301 • Rally - 2010172303

SATURDAY, APRIL 3, 2010

Conformation & Obedience - 2010172302 • Rally - 2010172304

SUNDAY, APRIL 4, 2010

SCOTTSBLUFF COUNTY FAIRGROUNDS

Events Center Building • 130625 County Road E • Mitchell, Nebraska 69357

SHOW HOURS • 7:00 am to 6:00 pm

THESE SHOWS WILL BE HELD INDOORS

Member: Dog Show Superintendents Association



American
Kennel Club
Annually Licensed
Superintendents

Tiffany R Fields • Nancy E Gines • John Goosen • Michele J Goosen
Candy E James • Christopher L James • H T (Terry) James • Tim E James
Dorothy Lippincott • John McDonald • Sandra McDonald
Antony M Onofrio • Jack David Onofrio • Patricia Onofrio • Sue Onofrio
Jimmie L Phillips • Mattie A Phillips • Glen Power • Paul D Ring • Jo Nell Rogers
Michael C Schmitt • Reggie Turner • Sharon Turner • Greg S Wetmore

PO Box 25764
Oklahoma City, Oklahoma 73125-0764
Phone: (405) 427-8181 • www.onofrio.com

PO Box 4660
Portland, Oregon 97208-4660
Phone: (503) 239-1080

OFFICERS

Marianne Relka	President
Helen Reinhardt	Vice President
Jeff Bott	Treasurer
Gayle Rojas	Secretary

3533 Spruce Drive, Scottsbluff NE 69361

BOARD OF DIRECTORS

Shirley Martischewsky • Suzanne Lilja-Kingma
Don Hall • Linda Veal • Sherrie Hall

SHOW COMMITTEE

Helen Reinhardt	Show Chairman
190446 County Rd G, Scottsbluff NE 69361	
Daughn Trapp	Obedience Chairman
Linda Veal	Rally Chairman

Officers of the Club & Members of the Board of Directors

COMMITTEES

Suzanne Lilja-Kingma	Prizes
Gayle Rojas	Catalog Advertising
Helen Reinhardt	Public Education
Marianne Relka	Hospitality
Joyce Bartlett	Vendor Booths
Linda Veal	Building & Grounds
Jeff Bott	RV & General Parking
Helen Reinhardt	Motels
Suzanne Lilja-Kingma	Publicity
Mary Wuest	Chief Ring Steward

ENTRY FEES • (including 50 cent AKC recording fee and \$3.00 AKC Event Service Fee)

Separate fee for each dog, each day

First entry of each dog	\$25.00
Additional entry of same dog, unless otherwise specified	\$20.00
Puppy & Bred-by-Exhibitor Classes	\$20.00
Junior Showmanship Competition ONLY	\$17.00
as an additional entry	\$12.00
Brace as a Unit	\$17.00

both dogs must be entered in another class

When a dog is entered in more than one class, the highest priced class is considered the first entry.

RALLY ENTRIES MUST INCLUDE DOG'S JUMP HEIGHT

RALLY ENTRY FEES • (including \$3.00 AKC recording fee)

Separate fee for each dog, each day

First entry of each dog	\$25.00
Additional entry of same dog	\$20.00

NOTICE: PLEASE PUT BREED & NAME OF SHOW ON CHECK.



CERTIFICATION

Permission has been granted by the American Kennel Club for the holding of this event under the American Kennel Club rules and regulations.

**AMERICAN
KENNEL CLUB®**

JAMES P CROWLEY, Secretary

• RIBBON/ROSETTE PRIZES WILL BE AS FOLLOWS •

REGULAR CLASSES	
First Prize.....	Blue
Second Prize.....	Red
Third Prize.....	Yellow
Fourth Prize.....	White
Winners.....	Purple
Reserve Winners.....	Purple and White
Best of Winners.....	Blue and White
Best of Breed.....	Purple and Gold
Best of Variety of Breed.....	Purple and Gold
Best of Opposite Sex to Best of Breed and to Best of Variety of Breed.....	Red and White
OBEDIENCE CLASSES	
Highest Scoring Dog in the Regular Obedience Classes.....	Blue and Gold
Highest Combined Score in Open B & Utility Obedience Classes.....	Blue & Green
Qualifying Score.....	Dark Green

RALLY CLASSES	
Qualifying Score.....	Dark Green
VARIETY GROUPS	
First Prize.....	Blue
Second Prize.....	Red
Third Prize.....	Yellow
Fourth Prize.....	White
Best in Show.....	Red, White and Blue
NON-REGULAR CLASSES	
First Prize.....	Rose
Second Prize.....	Brown
Third Prize.....	Light Green
Fourth Prize.....	Gray

• CLASSIFICATION •

Regular Classes

Puppy, Dogs
 6 months & under 9 months
 9 months & under 12 months
 Twelve to Eighteen Month, Dogs
 Novice, Dogs
 Amateur-Owner-Handler, Dogs
 Bred-by-Exhibitor, Dogs
 American-bred, Dogs
 Open, Dogs
 WINNERS, DOG

Puppy, Bitches
 6 months & under 9 months
 9 months & under 12 months
 Twelve to Eighteen Month, Bitches
 Novice, Bitches
 Amateur-Owner-Handler, Bitches
 Bred-by-Exhibitor, Bitches
 American-bred, Bitches
 Open, Bitches
 WINNERS, BITCH

Best of Breed (Variety) Competition

NON-REGULAR (ADDITIONAL) CLASSES Involving Multiple Dog Entries

As the judge's decision in the Non-Regular Classes involving Multiple Dog Entries is based on the merits of more than one dog or bitch, no one of the dogs or bitches making up the entry judged first in these classes will be eligible to compete for Best of Breed by virtue of having won these classes.

BRACE CLASS - Two dogs of the same Breed or Variety of Breed with one or more common owner and both dogs must be entered in another class.

The above classification is provided for all breeds (and varieties). Additional divisions, i.e. (age, color or weight) are in the breed list and must be indicated on the entry.

*** OPEN CLASS DIVISIONS**

DACHSHUNDS (ALL THREE VARIETIES): Miniature - 11 lbs & under & 12 mos old or over; Standard - Over 11 lbs & 11 lbs & under if less than 12 mos old

BOXERS: Brindle; Fawn

BULLMASTIFFS: Brindle; AOAC

DOBERMAN PINSCHERS: Black; AOAC

GREAT DANES: Brindle; Fawn; AOAC (Black, Blue, Harlequin, Mantle)

PUGS: Black; Fawn

BOSTON TERRIERS: Under 15 lbs; 15 lbs & over

CHINESE SHAR-PEI: Brushcoat; Horsecoat

DALMATIANS: Black Spotted; Liver Spotted

AUSTRALIAN SHEPHERDS: Blue Merle; Black; Red Merle; Red

COLLIES (ROUGH): Blue Merle; Sable & White; Tri-Color; White

SHETLAND SHEEPDOGS: Sable & White; AOAC

SHOW PHOTOGRAPHER

Kemp Photography
 PO Box 2062
 Sheridan WY 82801
 (307) 673-9437
 e-mail: kphoto@bresnan.net

JUNIOR SHOWMANSHIP COMPETITION

NOVICE JUNIOR CLASS - For Boys and Girls at least 9 and under 12 years of age on the day of the show who at the time entries close, have not won three (3) first place awards, with competition present, in a Novice Class at a licensed or member show.

NOVICE INTERMEDIATE CLASS - For Boys and Girls at least 12 and under 15 years of age on the day of the show who at the time entries close, have not won three (3) first place awards, with competition present, in a Novice Class at a licensed or member show.

NOVICE SENIOR CLASS - For Boys and Girls at least 15 and under 18 years of age on the day of the show who at the time entries close, have not won three (3) first place awards, with competition present, in a Novice Class at a licensed or member show.

OPEN JUNIOR CLASS - For Boys and Girls at least 9 and under 12 years of age on the day of the show who at the time entries close, have won three (3) first place awards in a Novice Class at a licensed or member show, with competition present in the Novice Class.

OPEN INTERMEDIATE CLASS - For Boys and Girls at least 12 and under 15 years of age on the day of the show who at the time entries close, have won three (3) first place awards in a Novice Class at a licensed or member show, with competition present in the Novice Class.

OPEN SENIOR CLASS - For Boys and Girls at least 15 and under 18 years of age on the day of the show who at the time entries close, have won three (3) first place awards in a Novice Class at a licensed or member show, with competition present in the Novice Class.

NOTICE: Junior Handlers must include their AKC JUNIOR HANDLER NUMBER on each entry.

You may obtain your junior identification number by calling the AKC, Judges Education Department, (919) 816-3776.

BE SURE ALL INFORMATION for Junior Showmanship Classes is entered on front and back of entry form.

JUDGES

Mr Eugene Blake	8946 E 60th St, Tulsa OK 74145
Mr Kenneth A Buxton	3215 Pine Arbor Trl, Kingwood TX 77345
Mrs Donna J Buxton	3215 Pine Arbor Trl, Kingwood TX 77345
Mrs Marilyn Little	Box 3093, Overgaard AZ 85933
Dr Harry Smith Jr.....	1 Barretts Chapel Ct, Durham NC 27705
Mr Donovan Thompson	PO Box 162137, Sacramento CA 95816
Mrs Cindy Vogels.....	3300 E Belleview Ave, Littleton CO 80121
Dorothy A Wysaski DVM.....	16850 E 2nd Ave, Aurora CO 80011

VARIETY GROUP JUDGES

SCOTTSBLUFF KENNEL CLUB (1)-SATURDAY

Mr Kenneth A Buxton.....	Sporting Group
Mr Eugene Blake	Hound Group
Mrs Donna J Buxton	Working Group
Dr Harry Smith Jr.....	Terrier Group
Dr Harry Smith Jr	Toy Group
Mr Kenneth A Buxton.....	Non-Sporting Group
Mr Donovan Thompson.....	Herding Group
Mrs Cindy Vogels	Best In Show

SCOTTSBLUFF KENNEL CLUB (2)-SUNDAY

Mrs Cindy Vogels.....	Sporting Group
Dr Harry Smith Jr	Hound Group
Mr Donovan Thompson	Working Group
Mrs Cindy Vogels	Terrier Group
Mr Eugene Blake	Toy Group
Mr Eugene Blake	Non-Sporting Group
Mrs Donna J Buxton.....	Herding Group
Mr Kenneth A Buxton	Best In Show

JUDGING ASSIGNMENTS

SPORTING BREEDS	SCBL1-(SAT)	SCBL2-(SUN)
Brittany	C Vogels	M Little
Pointers	C Vogels	E Blake
Pointers (German Shorthaired)	C Vogels	M Little
Pointers (German Wirehaired)	C Vogels	E Blake
Retrievers (Chesapeake Bay)	C Vogels	M Little
Retrievers (Curly-Coated)	C Vogels	E Blake

Retrievers (Flat-Coated)	C Vogels	M Little
Retrievers (Golden)	C Vogels	M Little
Retrievers (Labrador)	C Vogels	M Little
Retrievers (Nova Scotia Duck Tolling)	C Vogels	E Blake
Setters (English)	C Vogels	E Blake
Setters (Gordon)	C Vogels	E Blake
Setters (Irish)	C Vogels	E Blake
Setters (Irish Red And White)	C Vogels	E Blake
Spaniels (American Water)	C Vogels	E Blake
Spaniels (Boykin)	C Vogels	E Blake
Spaniels (Clumber)	C Vogels	E Blake
Spaniels (Cocker) Black	K A Buxton	C Vogels
Spaniels (Cocker) Ascob	K A Buxton	C Vogels
Spaniels (Cocker) Parti-Color	K A Buxton	C Vogels
Spaniels (English Cocker)	K A Buxton	C Vogels
Spaniels (English Springer)	K A Buxton	C Vogels
Spaniels (Field)	K A Buxton	C Vogels
Spaniels (Irish Water)	K A Buxton	C Vogels
Spaniels (Sussex)	K A Buxton	C Vogels
Spaniels (Welsh Springer)	K A Buxton	C Vogels
Spinoni Italiani	K A Buxton	C Vogels
Vizslas	K A Buxton	M Little
Weimaraners	K A Buxton	C Vogels
Wirehaired Pointing Griffons	K A Buxton	C Vogels

HOUD BREEDS	SCBL1-(SAT)	SCBL2-(SUN)
Afghan Hounds	E Blake	D Thompson
American Foxhounds	E Blake	D Thompson
Basenjis	E Blake	D Thompson
Basset Hounds	E Blake	D Thompson
Beagles (13 Inch)	E Blake	D Thompson
Beagles (15 Inch)	E Blake	D Thompson
Black & Tan Coonhounds	E Blake	D Thompson
Bloodhounds	E Blake	D Thompson
Bluetick Coonhounds	E Blake	H Smith Jr
Borzois	E Blake	D Thompson
Dachshunds (Longhaired)	E Blake*	D Thompson*
Dachshunds (Smooth)	E Blake*	D Thompson*
Dachshunds (Wirehaired)	E Blake*	D Thompson*
English Foxhounds	E Blake	D Thompson
Greyhounds	E Blake	D Thompson
Harriers	E Blake	H Smith Jr
Ibizan Hounds	E Blake	D Thompson
Irish Wolfhounds	E Blake	D Thompson
Norwegian Elkhounds	E Blake	D Thompson
Otterhounds	E Blake	D Thompson
Petits Bassets Griffons Vendeens	E Blake	D Thompson
Pharaoh Hounds	E Blake	D Thompson
Plotts	E Blake	H Smith Jr
Redbone Coonhounds	E Blake	H Smith Jr
Rhodesian Ridgebacks	E Blake	D Thompson
Salukis	E Blake	D Thompson
Scottish Deerhounds	E Blake	D Thompson
Whippets	E Blake	D Thompson

WORKING BREEDS	SCBL1-(SAT)	SCBL2-(SUN)
Akitas	D J Buxton	K A Buxton
Alaskan Malamutes	D J Buxton	K A Buxton
Anatolian Shepherd Dogs	D J Buxton	K A Buxton
Bernese Mountain Dogs	D J Buxton	K A Buxton
Black Russian Terriers	D J Buxton	D Thompson
Boxers	D J Buxton*	D Thompson*
Bullmastiffs	D J Buxton*	D Thompson*
Doberman Pinschers	D J Buxton*	D Thompson*
Dogues de Bordeaux	D J Buxton	D Thompson
German Pinschers	D J Buxton	D Thompson
Giant Schnauzers	D J Buxton	D Thompson
Great Danes	D J Buxton*	D Thompson*
Great Pyrenees	D J Buxton	D Thompson
Greater Swiss Mountain Dogs	D J Buxton	D Thompson

*** See page 3 for Open Class Divisions**

Komondorok	D J Buxton	D Thompson
Kuvaszok	D J Buxton	D Thompson
Mastiffs	D J Buxton	D Thompson
Neapolitan Mastiffs	D J Buxton	H Smith Jr
Newfoundlands	D J Buxton	H Smith Jr
Portuguese Water Dogs	D J Buxton	H Smith Jr
Rottweilers	D Thompson	H Smith Jr
Saint Bernards	D J Buxton	H Smith Jr
Samoyeds	D Thompson	D J Buxton
Siberian Huskies	D Thompson	D J Buxton
Standard Schnauzers	D J Buxton	H Smith Jr
Tibetan Mastiffs	D J Buxton	H Smith Jr

TERRIER BREEDS	SCBL1-(SAT)	SCBL2-(SUN)
Airedale Terriers	H Smith Jr	C Vogels
American Staffordshire Terriers	H Smith Jr	C Vogels
Australian Terriers	H Smith Jr	C Vogels
Bedlington Terriers	H Smith Jr	C Vogels
Border Terriers	H Smith Jr	C Vogels
Bull Terriers (Colored)	H Smith Jr	C Vogels
Bull Terriers (White)	H Smith Jr	C Vogels
Cairn Terriers	H Smith Jr	C Vogels
Dandie Dinmont Terriers	H Smith Jr	C Vogels
Fox Terriers (Smooth)	H Smith Jr	C Vogels
Fox Terriers (Wire)	H Smith Jr	C Vogels
Glen of Imaal Terriers	H Smith Jr	C Vogels
Irish Terriers	H Smith Jr	C Vogels
Kerry Blue Terriers	H Smith Jr	C Vogels
Lakeland Terriers	H Smith Jr	C Vogels
Manchester Terriers (Standard)	H Smith Jr	C Vogels
Miniature Bull Terriers	H Smith Jr	C Vogels
Miniature Schnauzers	H Smith Jr	C Vogels
Norfolk Terriers	H Smith Jr	C Vogels
Norwich Terriers	H Smith Jr	C Vogels
Parson Russell Terriers	H Smith Jr	C Vogels
Scottish Terriers	H Smith Jr	C Vogels
Sealyham Terriers	H Smith Jr	C Vogels
Skye Terriers	H Smith Jr	C Vogels
Soft Coated Wheaten Terriers	H Smith Jr	C Vogels
Staffordshire Bull Terriers	H Smith Jr	C Vogels
Welsh Terriers	H Smith Jr	C Vogels
West Highland White Terriers	H Smith Jr	C Vogels

TOY BREEDS	SCBL1-(SAT)	SCBL2-(SUN)
Affenpinschers	H Smith Jr	E Blake
Brussels Griffons	H Smith Jr	E Blake
Cavalier King Charles Spaniels	C Vogels	E Blake
Chihuahuas (Long Coat)	C Vogels	H Smith Jr
Chihuahuas (Smooth Coat)	C Vogels	H Smith Jr
Chinese Cresteds	C Vogels	H Smith Jr
English Toy Spaniels (B & P C)	H Smith Jr	E Blake
English Toy Spaniels (K C & R)	H Smith Jr	E Blake
Havanese	C Vogels	E Blake
Italian Greyhounds	C Vogels	E Blake
Japanese Chin	H Smith Jr	E Blake
Maltese	H Smith Jr	E Blake
Manchester Terriers (Toy)	C Vogels	E Blake
Miniature Pinschers	H Smith Jr	E Blake
Papillons	E Blake	H Smith Jr
Pekingese	C Vogels	E Blake
Pomeranians	H Smith Jr	E Blake
Poodles (Toy)	C Vogels	E Blake
Pugs	E Blake*	C Vogels*
Shih Tzu	E Blake	H Smith Jr
Silky Terriers	C Vogels	E Blake
Toy Fox Terriers	H Smith Jr	E Blake
Yorkshire Terriers	C Vogels	E Blake

*** See page 3 for Open Class Divisions**

NON-SPORTING BREEDS	SCBL1-(SAT)	SCBL2-(SUN)
American Eskimo Dogs	K A Buxton	D J Buxton
Bichons Frises	K A Buxton	D J Buxton
Boston Terriers	K A Buxton*	D J Buxton*
Bulldogs	K A Buxton	E Blake
Chinese Shar-Pei	K A Buxton*	D J Buxton*
Chow Chows	K A Buxton	D J Buxton
Dalmatians	K A Buxton*	D J Buxton*
Finnish Spitz	K A Buxton	E Blake
French Bulldogs	K A Buxton	H Smith Jr
Keeshonden	K A Buxton	E Blake
Lhasa Apsos	K A Buxton	E Blake
Lowchen	K A Buxton	H Smith Jr
Poodles (Miniature)	K A Buxton	C Vogels
Poodles (Standard)	K A Buxton	C Vogels
Schipperkes	K A Buxton	D J Buxton
Shiba Inu	K A Buxton	E Blake
Tibetan Spaniels	K A Buxton	E Blake
Tibetan Terriers	K A Buxton	E Blake

HERDING BREEDS	SCBL1-(SAT)	SCBL2-(SUN)
Australian Cattle Dogs	D Thompson	D J Buxton
Australian Shepherds	D Thompson*	D J Buxton*
Bearded Collies	D Thompson	D J Buxton
Beaucerons	D Thompson	D J Buxton
Belgian Malinois	D Thompson	D J Buxton
Belgian Sheepdogs	D Thompson	D J Buxton
Belgian Tervuren	D Thompson	D J Buxton
Border Collies	D Thompson	D J Buxton
Bouvier des Flandres	D Thompson	D J Buxton
Briards	D Thompson	D J Buxton
Canaan Dogs	D Thompson	D J Buxton
Cardigan Welsh Corgis	D Thompson	D J Buxton
Collies (Rough)	D Thompson*	D J Buxton*
Collies (Smooth)	D Thompson	D J Buxton
German Shepherd Dogs	D Thompson	D J Buxton
Norwegian Buhunds	D Thompson	D J Buxton
Old English Sheepdogs	D Thompson	D J Buxton
Pembroke Welsh Corgis	D Thompson	D J Buxton
Polish Lowland Sheepdogs	D Thompson	D J Buxton
Pulik	D Thompson	D J Buxton
Pyrenean Shepherds	D Thompson	D J Buxton
Shetland Sheepdogs	D Thompson*	D J Buxton*
Swedish Vallhunds	D Thompson	D J Buxton

MISC CLASS	SCBL1-(SAT)	SCBL2-(SUN)
American English Coonhounds, Cane Corso, Cesky Terriers, Entlebucher Mountain Dogs, Finnish Lapphund, Icelandic Sheepdogs, Leonberger, Norwegian Lundehunds, Russell Terriers, Treeing Walker Coonhounds & Xoloitzcuintli.		

There will be Puppy and Open Classes for each of the Miscellaneous Breeds in each sex.

E Blake H Smith Jr

OBEDIENCE CLASSES	SCBL1-(SAT)	SCBL2-(SUN)
Novice A Class	M Little	K A Buxton
Novice B Class	M Little	K A Buxton
Open A Class	M Little	K A Buxton
Open B Class	M Little	K A Buxton
Utility A Class	M Little	K A Buxton
Utility B Class	M Little	K A Buxton

RALLY CLASSES	SCBL1-(SAT)	SCBL2-(SUN)
Rally Novice A	D A Wysaski DVM	D A Wysaski DVM
Rally Novice B	D A Wysaski DVM	D A Wysaski DVM
Rally Advanced A	D A Wysaski DVM	D A Wysaski DVM
Rally Advanced B	D A Wysaski DVM	D A Wysaski DVM
Rally Excellent A	D A Wysaski DVM	D A Wysaski DVM
Rally Excellent B	D A Wysaski DVM	D A Wysaski DVM

JUNIOR SHOWMANSHIP	SCBL1-(SAT)	SCBL2-(SUN)
	C Vogels	M Little

** See page 3 for Open Class Divisions*

ATTENTION EXHIBITORS

The Show Site will be available to exhibitors at 1:00 pm Friday, April 2, 2010. Dogs must be removed from the show site immediately following Best in Show judging on Sunday.

Anyone who would like to steward please contact Mary Wuest at (308) 631-1833.

Exhibitors will be responsible for the cleanliness of their areas.

No double handling will be permitted at this show. Individuals who attempt to double handle from outside the ring in any manner will be subject to action by the Show Committee.

RV parking only will be allowed in designated RV parking areas: \$25.00 per night advance reservation, \$30.00 per night day of show. Deadline for advance reservation is March 11, 2009. Send reservations to: Jeff Bott, Box 1097, Scottsbluff NE 69363. Fees will be collected by SKC members. Large vehicles may require two spaces. 15 Amp 110 volt electricity for each spot with water available. There are only 70 spaces. There is a dump station available on the grounds.

Exhibitors will be responsible for clean-up of their parking and camp site.

VENDOR BOOTHS: 10 feet by 10 feet - \$75.00 for weekend includes 6 or 8 foot table & 2 chairs. Additional tables & chairs available. Reservations must be made by March 11, 2010. If reservations are reserved by February 15, 2010, vendors will receive a 10% discount & will be listed in the catalogue. Contact: Joyce Bartlett, Heads to Tails Grooming, PO Box 986, Scottsbluff NE 69363 • (308) 635-7380.

No vendors in the Events Center Building.

Grooming in Sandford Hall, 75 feet west of Events Center Building. No exercise pens in the grooming area. Crates may have to be stacked. Sandford Hall has been designated a Historical Building; therefore, extreme caution must be used in care of building. **NO TAPE ALLOWED TO MARK GROOMING AREA ON THE FLOOR.** Additional grooming in Quonset Building, north of Events Center & under stadium - south of Events Center. Grooming - Additional grooming in open-sided show barn, north of Events Center, electrical outlets available.

No crating or exercise pens in the Events Center Building. Limited crating only for handicapped & to be removed immediately after breed judging.

On Sunday, April 4, 2010, groups may be judged two at a time.

EXHIBITORS PLEASE NOTE: There will be a very limited amount of chairs designated for elderly & handicap seating at ringside. Please furnish your own chairs.

This Club does not agree to arbitrate claims as set forth on the Official AKC entry form for this event.

At the sole discretion of the judge, the following breeds may be judged on a ramp: Clumber Spaniels, Sussex Spaniels, Basset Hounds, Whippets, Irish Terriers, Kerry Blue Terriers, Soft Coated Wheaten Terriers, Staffordshire Bull Terriers, Bulldogs, Chinese Shar-Pei, Chow Chows, Keeshonden & Polish Lowland Sheepdogs. Ramps may be used in emergency situations to judge any breed. (In an emergency situation, an exhibitor does have the option of withdrawing their entry and receiving a refund)

NEW EXHIBITOR BRIEFING on Saturday. Check Judging Program for time & location.

A Recording Fee of 50 cents for each dog and an AKC Event Service Fee of \$3.00 will be required for each recordable single entry class at any Licensed or Member Club Show or Obedience Trial. (American Kennel Club Rule, Chapter 11, Section 2). A \$3.00 AKC Recording Fee will be required for each entry in Rally. (American Kennel Club Rally Regulation, Chapter 1, Section 3) These Fees are paid to the American Kennel Club.

CANADIAN EXHIBITORS MUST SUBMIT ENTRIES WITH CHECKS DRAWN ON U.S. ACCOUNTS OR WITH INTERNATIONAL MONEY ORDERS IN U.S. FUNDS.

There will be no refund for duplicate entries.

Dogs need be present only for scheduled judging and will be released if not needed for further judging.

Dogs allowed in rings during judging only.

Dogs must be ready for judging. Neither the club nor its Superintendents will be responsible or obligated to furnish any service for notifying exhibitors or their agents of Breed or Class Judging. Judges need not wait for any dog holding up a class. **Owners or agents alone are responsible for the presence of their dogs in the judging rings.**

The Club reserves the right to substitute a prize of equal or greater value.

All trophies must be claimed the day of the show - None will be mailed.

All checks issued as prizes are the sole responsibility of the recipient. Lost, stolen and/or misplaced checks will not be replaced. Checks are valid for 90 days. The Superintendent is not able to cash checks.

RETURNED CHECKS/DECLINED CREDIT/DEBIT CARDS do not constitute a valid entry fee. Fees must be paid in guaranteed funds. Checks will not be accepted. The Superintendent will add a fee for completing the transaction and/or reprocessing the entries. Repeated occurrences from the same exhibitors may result in their being put on a CASH ONLY basis.

Entry Fee will not be refunded in the event that a dog is absent, disqualified, excused by Veterinarian or judge or barred from competition by action of the Show Committee.

Exhibitors should follow their veterinarian's recommendation to assure their dogs are free of internal and external parasites, any communicable diseases and have appropriate vaccinations.

No entry fees will be refunded if the Show cannot open or be completed by reason of riots, civil disturbances, fire, extreme and/or dangerous weather conditions, an Act of God, public emergency, act of a public enemy, strikes or any other cause beyond the control of the Club or the Superintendent.

The show giving Club, the Show Superintendent, their agents, employees, etc, assume no responsibility for any loss, damage or injury sustained by exhibitors, handlers, or to any of their dogs or property and further assume no responsibility for injury to children.

No entry shall be made and no entry shall be accepted which specifies any condition as to its acceptance. Entries will not be accepted without fees, signatures or the "Agreement" on the reverse side of the Official AKC

Entry Form.

Changes, additions or corrections to entry forms must be received in writing or by telegram prior to close of entries. Those received by telephone are not acceptable.

Refunds of \$3.00 & less will not be issued due to the costs of processing.

An administrative fee of \$2.00 will be charged for all cancellations or changes made prior to closing of entries.

EXHIBITORS NOTE: Please notify Superintendent of any change of address.

Jack Onofrio Dog Shows Telephone Entry Service phone number (405) 427-0405 or toll free (888) 421-0405: This is for Telephone Entry Service ONLY. For Mastercard/Discover/Visa/American Express cardholders. A \$4.75 charge will be added to each entry for use of this service. Mon, Tues & Thurs 7:00 am to 6:00 pm; Wed 7:00 am to 12:00 noon; Friday 7:00 am to 4:30 pm.

Facsimile Machine entries for this show will be accepted up to closing time. Both sides of entry form must be submitted. For Mastercard/Discover/Visa/American Express cardholders. A \$5.50 charge will be added to each entry for use of this service. Be sure to include cardholder's name, address, card number, expiration date & signature. Phone number: (405) 427-5241. This is for Facsimile Machine ONLY. Incomplete or illegible FAX entries are not acceptable as a valid entry in a show. Proof of transmission is not proof of receipt of a legible or complete transmission (under AKC Rule Chapter 11, Section 4).

Onofrio Online Entry at www.onofrio.com for entries made with Mastercard/Discover/Visa/American Express. A \$2.50 charge will be added to each entry for use of this service.

Special Delivery & Overnight Delivery Mail Addresses: 3401 NE 23rd St, Oklahoma City, Oklahoma 73121-2447 or West Coast exhibitors: 2710 SE 50th Ave, Portland, Oregon 97206-1538. **THESE ARE FOR SPECIAL & OVERNIGHT DELIVERY MAIL ONLY!**

ROUTES TO THE SHOW

Take Highway 26 into Mitchell, turn south at the Junction of Hwy 26 & Hwy 29. Cross the railroad tracks & immediately turn west (right).

Take Highway 92/29W to Mitchell junction. Turn north on Hwy 29 & go approximately 6 miles into Mitchell. Turn west just before crossing the railroad tracks.

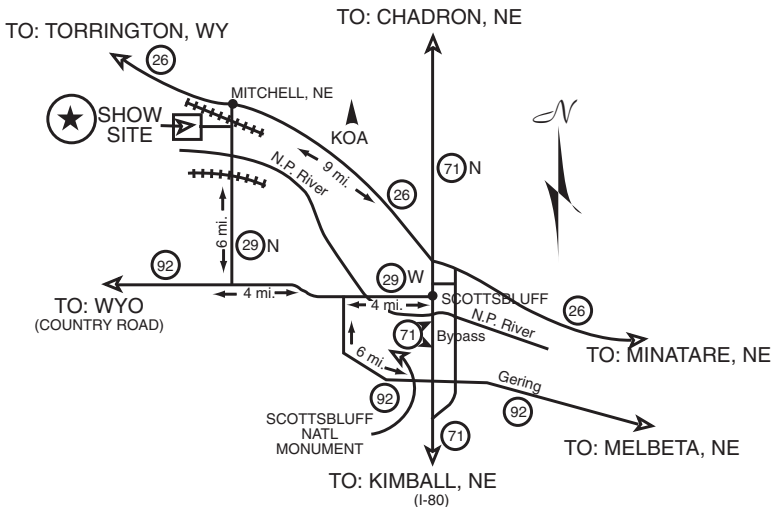

HOTELS & MOTELS THAT WILL ACCEPT DOGS

American Inn	(308) 632-7108
606 E 27th St, Scottsbluff NE • \$6.00 dog charge	
Capri Motel.....	(308) 635-2057
2424 Ave I, Scottsbluff NE • \$5.00 per dog charge	
Cavalier Motel.....	(308) 635-3176
3655 N 10th St, Gering NE • \$5.00 per dog charge	
Comfort Inn	(308) 632-7510
1902 21st Ave, Scottsbluff NE 69361	
Days Inn	1-800-597-3111 or (308) 635-3111
1901 21st Ave, Scottsbluff NE • \$10.00 dog fee	
Circle-S Lodge	(308) 436-2157
410 M St, Gering NE • \$10.00 dog charge • Newly remodelled • Ask for special dog show rates	
Grandma's Inn	(307) 532-4064
Hwy 26 West, Torrington WY (22 miles from show site)	
\$5.00 per dog charge	
Meadowlark Motor Inn & Restaurant.....	(308) 262-0557
N Hwy 385, Bridgeport NE (46 miles from show site) • \$5.00 per dog	
Monument Inn & Suites.....	(866) 436-1950
1130 M St, Gering NE • \$15.00 dog charge	
Oak Tree Inn	(308) 247-2111
707 E Webster, Morrill NE • \$5.00 dog charge - 6 miles from show site	
Super 8 Motel	1-800-800-8000 or (308) 635-1600
2202 Delta Dr, Scottsbluff NE • \$10.00 per dog charge	
The Sportsman Inn.....	(308) 632-6012
80349 County Rd 19 • \$10.00 per day dog charge	

RV PARKS THAT WILL ACCEPT DOGS

Robidoux RV Park.....	(308) 436-2046
585 Five Rocks Rd, Gering NE 69341	
Route 26 Campgrounds (Formerly KOA).....	(308) 635-3760
Hwy 26, west of Scottsbluff, NE	

Attention Exhibitors • Ask for Dog Show Rates

ATTENTION EXHIBITORS: We have acquired several additional motels that will accept dogs on a trial basis. If this privilege is abused, we will lose these motels as well as others.

EACH EXHIBITOR WILL BE HELD RESPONSIBLE FOR CLEANING UP AFTER THEIR DOGS ON THE GROUNDS OF THESE MOTELS. DAMAGES TO ROOMS OR GROUNDS WILL BE REPORTED TO THE EVENT COMMITTEE AND TO THE AKC.

SHOW VETERINARIAN

(ON CALL)

Animal Health Center
Paul Ragone DVM, Cristin Reese DVM & Jackie Moreno DVM
1906 24 Hwy 26 West
(308) 635-0116

(HOURS)

Mon-Fri 8:00 am to 6:00 pm • Sat 9:00 am to 12:00 pm
Evenings & Saturdays (after 12:00 noon) by Appointment

DIRECTIONS TO VETERINARIAN'S OFFICE: There are no 24 hour animal emergency clinics in our area. The nearest most convenient veterinarian's office is located 1.7 miles west of Hwy 26 & 71 intersection, Scottsbluff NE. Approximately 6 miles from show site.

OUR HOST HOTEL
WELCOMES YOU AND YOUR DOG!



COMFORT INN
1902 21ST Avenue
Scottsbluff, Nebraska 69361
1-800-228-5150
308-632-7510

Deluxe Continental Breakfast
Pool

WE LOVE DOGS!!

ATTENTION EXHIBITORS

The Scottsbluff Kennel Club offers a Ribbon to any dog finishing an Obedience or Rally Title at these shows.

SATURDAY
BEST IN SHOW & VARIETY GROUP PRIZES
FOR BEST IN SHOW

\$50.00

ROSETTE

Offered by the Scottsbluff Kennel Club

FOR FIRST IN EACH VARIETY GROUP

EMBROIDERED TOWEL

Sporting Group

Offered by Nancy Johnson

Hound Group

Offered by Jeff Bott

Working Group

Offered by Marty & Mary Patterson

Terrier Group

Offered by Kemp's Photography

Toy Group

Offered by Shirley & Lori Martischewsky in memory of Addie, O.J. & Tessa

Non-Sporting Group

Offered by Marianne Relka

Herding Group

Offered by Joyce Bartlett, Heads to Tails Grooming

FOR FIRST, SECOND, THIRD & FOURTH IN EACH VARIETY GROUP

ROSETTE

Offered by the Scottsbluff Kennel Club

BREED PRIZES

Only when a prize is listed under a breed, unless otherwise indicated, it will be a Breed Refrigerator Magnet by Cuny.

SPORTING BREEDS

RETRIEVERS (CHESAPEAKE BAY)

BEST OF BREED - Offered by Shirley Rodgers

RETRIEVERS (LABRADOR)

BEST OF BREED - Offered by Nancy Johnson

SPANIELS (ENGLISH COCKER)

BEST OF BREED - Offered by Helen Reinhardt

WORKING BREEDS

DOBERMAN PINSCHERS

BEST OF BREED - Offered by Marty & Mary Patterson

NEWFOUNDLANDS

BEST OF BREED - Offered by Don & Sherrie Hall

SAMOYEDS

BEST OF BREED - Offered by Jeff Bott

TERRIER BREEDS

LAKELAND TERRIERS

BEST OF BREED - Offered by Suzanne Lilja-Kingma

SCOTTISH TERRIERS

BEST OF BREED - Offered by Karen Lilja

TOY BREEDS

CHIHUAHUAS (SMOOTH COAT)

BEST OF VARIETY - Offered by Gayle Rojas

HAVANESE

BEST OF BREED - Offered by Linda Veal

MINIATURE PINSCHERS

BEST OF BREED - Offered by Gayle Rojas

PUGS

BEST OF BREED - Offered by Shirley & Lori Martischewsky

NON-SPORTING

BULLDOGS

BEST OF BREED - Offered by Marianne Relka

JUNIOR SHOWMANSHIP COMPETITION PRIZES

BEST JUNIOR HANDLER - 8 x 10 Inch Photo offered by Kemp Photography

BEST JUNIOR HANDLER - \$25.00 Hathaway Show Supplies Gift Certificate (not redeemable for cash) offered by the Scottsbluff Kennel Club

FIRST IN EACH CLASS - \$15.00 Hathaway Show Supplies Gift Certificate (not redeemable for cash) offered by the Scottsbluff Kennel Club



The following prizes are offered by the Junior Achievement Challenge.

BEST JUNIOR HANDLER - Large Rosette

FIRST IN EACH CLASS - 1 Group of AKC Breed Standards (Junior's Choice)

FIRST IN EACH CLASS - Junior Achievement Challenge Item

OBEDIENCE TRIAL PRIZES

Qualifying score required for all prizes.

A Dark Green Qualifying Ribbon will be given to each dog attaining a Qualifying Score.

PLEASE NOTE: Refund of entry fees for bitches entered in Obedience that come in season after closing date of this show may be obtained provided that a veterinarian's certificate and a request in writing is received by the Show Superintendent before the start of the show

Move-ups will be allowed at this trial per AKC Regulations.

FOR HIGHEST SCORING DOG IN REGULAR CLASSES

\$50.00

ROSETTE

Offered by the Scottsbluff Kennel Club

FOR HIGHEST COMBINED SCORE IN OPEN B & UTILITY CLASSES

\$25.00

Offered by Kemp Photography

ROSETTE

Offered by the Scottsbluff Kennel Club

FOR FIRST IN EACH CLASS

PET LOVERS TRAVEL KIT

Offered by the Scottsbluff Kennel Club

JAC OBEDIENCE PRIZES

ALL JUNIOR HANDLERS (9 YRS & UNDER 18 YRS) AWARDED A QUALIFYING SCORE

- JAC Item offered by the Junior Achievement Challenge



RALLY ENTRIES MUST INCLUDE DOG'S JUMP HEIGHT

RALLY TRIAL PRIZES

Qualifying score required for all prizes.

A Dark Green Qualifying Ribbon will be given to each dog attaining a Qualifying Score.

PLEASE NOTE: Refund of entry fees for bitches entered in Rally that come in season after closing date of this show may be obtained provided that a veterinarian's certificate and a request in writing is received by the Show Superintendent before the start of the show.

Move-ups will be allowed at this trial per AKC Regulations.

FOR FIRST IN EACH CLASS

PET LOVERS TRAVEL KIT

Offered by the Scottsbluff Kennel Club

SUNDAY

BEST IN SHOW & VARIETY GROUP PRIZES

FOR BEST IN SHOW

\$50.00

ROSETTE

Offered by the Scottsbluff Kennel Club

FOR FIRST IN EACH VARIETY GROUP

EMBROIDERED PHOTO DUFFLE BAG

Sporting Group

Offered by Helen Reinhardt

Hound Group

Offered by Jeff Bott

Working Group

Offered by Marty & Mary Patterson

Terrier Group

Offered by Suzanne Lilja-Kingma

Toy Group

Offered by Gayle Rojas

Non-Sporting Group

Offered by Don & Sherrie Hall

Herding Group

Offered by Kemp Photography

FOR FIRST, SECOND, THIRD & FOURTH IN EACH VARIETY GROUP

ROSETTE

Offered by the Scottsbluff Kennel Club

BREED PRIZES

Only when a prize is listed under a breed, unless otherwise indicated, it will be a Photo Wristlet.

SPORTING BREEDS

RETRIEVERS (CHESAPEAKE BAY)

BEST OF BREED - Offered by Shirley Rodgers

RETRIEVERS (LABRADOR)

BEST OF BREED - Offered by Nancy Johnson

SPANIELS (ENGLISH COCKER)

BEST OF BREED - Offered by Helen Reinhardt

WORKING BREEDS

DOBERMAN PINSCHERS

BEST OF BREED - Offered by Marty & Mary Patterson

NEWFOUNDLANDS

BEST OF BREED - Offered by Don & Sherrie Hall

SAMOYEDS

BEST OF BREED - Offered by Jeff Bott

TERRIER BREEDS

LAKELAND TERRIERS

BEST OF BREED - Offered by Suzanne Lilja-Kingma

SCOTTISH TERRIERS

BEST OF BREED - Offered by Karen Lilja

TOY BREEDS

CHIHUAHUAS (SMOOTH COAT)

BEST OF VARIETY - Offered by Gayle Rojas

HAVANESE

BEST OF BREED - Offered by Linda Veal

MINIATURE PINSCHERS

BEST OF BREED - Offered by Gayle Rojas

PUGS

BEST OF BREED - Offered by Shirley & Lori Martischewsky

NON-SPORTING BREEDS

BULLDOGS

BEST OF BREED - Offered by Marianne Relka

JUNIOR SHOWMANSHIP COMPETITION PRIZES

BEST JUNIOR HANDLER - 8 x 10 Inch Photo offered by Kemp Photography

BEST JUNIOR HANDLER - \$25.00 Hathaway Show Supplies Gift Certificate (not redeemable for cash) offered by the Scottsbluff Kennel Club

FIRST IN EACH CLASS - \$15.00 Hathaway Show Supplies Gift Certificate (not redeemable for cash) offered by the Scottsbluff Kennel Club



The following prizes are offered by the Junior Achievement Challenge.

BEST JUNIOR HANDLER - Large Rosette

FIRST IN EACH CLASS - 1 Group of AKC Breed Standards (Junior's Choice)

FIRST IN EACH CLASS - Junior Achievement Challenge Item

OBEDIENCE TRIAL PRIZES

Qualifying score required for all prizes.

A Dark Green Qualifying Ribbon will be given to each dog attaining a Qualifying Score.

PLEASE NOTE: Refund of entry fees for bitches entered in Obedience that come in season after closing date of this show may be obtained provided that a veterinarian's certificate and a request in writing is received by the Show Superintendent before the start of the show.

Move-ups will be allowed at this trial per AKC Regulations.

FOR HIGHEST SCORING DOG IN REGULAR CLASSES

\$50.00

ROSETTE

Offered by the Scottsbluff Kennel Club

FOR HIGHEST COMBINED SCORE IN OPEN B & UTILITY CLASSES

\$25.00

Offered by Kemp Photography

ROSETTE

Offered by the Scottsbluff Kennel Club

FOR FIRST IN EACH CLASS

ACCESS BACKPACK

Offered by the Scottsbluff Kennel Club



JAC OBEDIENCE PRIZES

ALL JUNIOR HANDLERS (9 YRS & UNDER 18 YRS) AWARDED A QUALIFYING SCORE
- JAC Item offered by the Junior Achievement Challenge

RALLY ENTRIES MUST INCLUDE DOG'S JUMP HEIGHT

RALLY TRIAL PRIZES

Qualifying score required for all prizes.

A Dark Green Qualifying Ribbon will be given to each dog attaining a Qualifying Score.

PLEASE NOTE: Refund of entry fees for bitches entered in Rally that come in season after closing date of this show may be obtained provided that a veterinarian's certificate and a request in writing is received by the Show Superintendent before the start of the show.

Move-ups will be allowed at this trial per AKC Regulations.

FOR FIRST IN EACH CLASS

ACCESS BACKPACK

Offered by the Scottsbluff Kennel Club

OFFICIAL AMERICAN KENNEL CLUB ENTRY FORM

BOTH SIDES OF ENTRY FORM MUST BE SUBMITTED

Appropriate Box(es) MUST BE CHECKED

All Breed Dog Shows, Obedience Trials & Rally Trials

SCOTTSBLUFF KENNEL CLUB **SATURDAY, APRIL 3, 2010** **SUNDAY, APRIL 4, 2010**

SCOTTSBLUFF COUNTY FAIRGROUNDS

Events Center Building • 130625 County Road E • Mitchell, Nebraska 69357

See page 2 for entry fees**ENTRIES CLOSE WEDNESDAY NOON, MARCH 17, 2010** at Superintendent's Office.**MAIL ENTRIES** with Fees Payable to **JACK ONOFRIO**, PO Box 25764, Oklahoma City, Oklahoma 73125-0764 or West Coast exhibitors: PO Box 4660, Portland, Oregon 97208-4660.**NOTICE: PLEASE PUT BREED & NAME OF SHOW ON CHECKS. I ENCLOSE \$_____ for entry fees. IMPORTANT - Read Carefully Instructions on Reverse Side Before Filling Out. Numbers in the boxes indicate sections of the instructions relevant to the information needed in that box. (PLEASE PRINT)**

BREED		VARIETY (1)	SEX
DOG (2) (3) SHOW CLASS		CLASS (3) DIVISION Weight, Color, Etc.	
ADDITIONAL CLASSES	OBEDIENCE CLASS (Jump Height)	RALLY CLASS (Jump Height)	JR. SHOWMANSHIP CLASS
NAME OF (See Back) JUNIOR HANDLER (if any)		JR. HANDLER AKC #	
FULL NAME OF DOG			
<input type="checkbox"/> AKC® REG. NO.		Enter number here	DATE OF BIRTH
<input type="checkbox"/> PAL NO.			PLACE OF BIRTH (list country)
<input type="checkbox"/> FOREIGN REG. NO. & COUNTRY			Do not print the above in the catalog

BREEDER**SIRE****DAM**

Exhibitor's Code _____

ACTUAL OWNER(S) [4] _____

(Please Print)

OWNER'S ADDRESS _____**CITY** _____**STATE** _____**ZIP + 4** _____**NAME OF OWNER'S AGENT
(IF ANY) AT THE SHOW****CODE #** _____

I CERTIFY that I am the actual owner of the dog, or that I am the duly authorized agent of the actual owner whose name I have entered above. In consideration of the acceptance of this entry, I (we) agree to abide by the rules and regulations of the American Kennel Club in effect at the time of this event, and by any additional rules and regulations appearing in the premium list for this event, and further agree to be bound by the "Agreement" printed on the reverse side of this entry form. I (we) certify and represent that the dog entered is not a hazard to persons or other dogs. This entry is submitted for acceptance on the foregoing representation and Agreement. I (we) agree to conduct myself (ourselves) in accordance with all such Rules and Regulations (including all provisions applying to discipline) and to abide by any decisions made in accord with them.

**SIGNATURE of owner or his agent
duly authorized to make this entry** _____

Telephone () _____

Are you a new exhibitor? Yes No **Email address:** _____

(An acknowledgement or receipt of entry may be sent to this email address):

AGREEMENT

I (we) agree that the club holding this event has the right to refuse this entry for cause which the club shall deem sufficient. In consideration of the acceptance of this entry and of the holding of this event and of the opportunity to have the dog judged and to win prizes, ribbons, or trophies, I (we) agree to hold the AKC, the event-giving club, their members, directors, governors, officers, agents, superintendents or event secretary and the owner and/or lessor of the premises and any provider of services that are necessary to hold this event and any employees or volunteers of the aforementioned parties, and any AKC approved judge, judging at this event, harmless from any claim for loss or injury which may be alleged to have been caused directly or indirectly to any person or thing by the act of this dog while in or about the event premises or grounds or near any entrance thereto, and I (we) personally assume all responsibility and liability for any such claim; and I (we) further agree to hold the aforementioned parties harmless from any claim for loss, injury or damage to this dog.

Additionally, I (we) hereby assume the sole responsibility for and agree to indemnify, defend and save the aforementioned parties harmless from any and all loss and expense (including legal fees) by reason of the liability imposed by law upon any of the aforementioned parties for damage because of bodily injuries, including death at any time resulting therefrom, sustained by any person or persons, including myself (ourselves) or on account of damage to property, arising out of or in consequence of my (our) participation in this event, however such injuries, death or property damage may be caused, and whether or not the same may have been caused or may be alleged to have been caused by the negligence of the aforementioned parties or any of their employees, agents, or any other persons. **I (WE) AGREE THAT ANY CAUSE OF ACTION, CONTROVERSY OR CLAIM ARISING OUT OF OR RELATED TO THE ENTRY, EXHIBITION OR ATTENDANCE AT THE EVENT BETWEEN THE AKC AND THE EVENT-GIVING CLUB (UNLESS OTHERWISE STATED IN ITS PREMIUM LIST) AND MYSELF (OURSELVES) OR AS TO THE CONSTRUCTION, INTERPRETATION AND EFFECT OF THIS AGREEMENT SHALL BE SETTLED BY ARBITRATION PURSUANT TO THE APPLICABLE RULES OF THE AMERICAN ARBITRATION ASSOCIATION. HOWEVER, PRIOR TO ARBITRATION ALL APPLICABLE AKC BYLAWS, RULES, REGULATIONS AND PROCEDURES MUST FIRST BE FOLLOWED AS SET FORTH IN THE AKC CHARTER AND BYLAWS, RULES, REGULATIONS, PUBLISHED POLICIES AND GUIDELINES.**

INSTRUCTIONS

- (Variety) if you are entering a dog of breed in which there are varieties for show purposes, please designate the particular variety you are entering i.e., Cocker Spaniel (solid color black, ASCOB, parti-color). Beagles (not exceeding 13 in. over 13 in. but not exceeding 15 in.). Dachshunds (longhaired, smooth, wirehaired), Bull Terriers (colored, white), Manchester Terriers (standard, toy), Chihuahuas (smooth coat, long coat), English Toy Spaniels (King Charles and Ruby, Blenheim and Prince Charles), Poodles (toy, miniature, standard), Collies (rough, smooth),
 - The following categories of dogs may be entered and shown in Best of Breed competition; Dogs that are Champions of Record and dogs which, according to their owner's records, have completed the requirements for a championship, but whose championships are unconfirmed. The showing of unconfirmed Champions in Best of Breed competition is limited to a period of 90 days from the date of the show where the dog completed the requirements for a championship.
 - (Event Class) Consult the classification in this premium list. If the event class in which you are entering your dog is divided, then, in addition to designating the class, specify the particular division of the class in which you are entering your dog, i.e., age division, color division, weight division.
 - A dog must be entered in the name of the person who actually owned it at the time entries for an event closed. If a registered dog has been acquired by a new owner, it must be entered in the name of its new owner in any event for which entries closed after the date of acquirement, regardless of whether the new owner has received the registration certificate indicating that the dog is recorded in his name. State on entry form whether transfer application has been mailed to the A.K.C. (For complete rules refer to Chapter 11, Section 3).
 - Dogs entering mixed breed classes (eligible only in standalone Agility, Obedience, and Rally trials) should mark Breed as "MIXED BREED". Variety, Breeder, Sire, Dam information shall remain blank for mixed breed entrants.
-

JUNIOR SHOWMANSHIP. If this entry is for Jr Showmanship, please give the following information:

AKC JR HANDLER #

JR.'S DATE OF BIRTH

The above number **MUST** be included. Should you not have your Junior Handler number, this may be obtained from the American Kennel Club. Phone: (919) 816-3776.

By signing the entry form I (we) certify that the Junior Showman does not now, and will not at any time, act as an agent/handler for pay while continuing to compete in Junior Showmanship.

ADDRESS _____

CITY _____

STATE _____

ZIP + 4 _____

■ If Jr. Handler is not the owner of the dog identified on

the face of this form, what is the relationship of the Jr. Handler to the owner?

OFFICIAL AMERICAN KENNEL CLUB ENTRY FORM

BOTH SIDES OF ENTRY FORM MUST BE SUBMITTED

Appropriate Box(es) MUST BE CHECKED

All Breed Dog Shows, Obedience Trials & Rally Trials

SCOTTSBLUFF KENNEL CLUB **SATURDAY, APRIL 3, 2010** **SUNDAY, APRIL 4, 2010**

SCOTTSBLUFF COUNTY FAIRGROUNDS

Events Center Building • 130625 County Road E • Mitchell, Nebraska 69357

See page 2 for entry fees**ENTRIES CLOSE WEDNESDAY NOON, MARCH 17, 2010** at Superintendent's Office.**MAIL ENTRIES** with Fees Payable to **JACK ONOFRIO**, PO Box 25764, Oklahoma City, Oklahoma 73125-0764 or West Coast exhibitors: PO Box 4660, Portland, Oregon 97208-4660.

NOTICE: PLEASE PUT BREED & NAME OF SHOW ON CHECKS. I ENCLOSE \$_____ for entry fees.
IMPORTANT - Read Carefully Instructions on Reverse Side Before Filling Out. Numbers in the boxes
indicate sections of the instructions relevant to the information needed in that box. (PLEASE PRINT)

BREED		VARIETY (1)	SEX
DOG (2) (3) SHOW CLASS		CLASS (3) DIVISION Weight, Color, Etc.	
ADDITIONAL CLASSES	OBEDIENCE CLASS (Jump Height)	RALLY CLASS (Jump Height)	JR. SHOWMANSHIP CLASS
NAME OF (See Back) JUNIOR HANDLER (if any)		JR. HANDLER AKC #	
FULL NAME OF DOG			
<input type="checkbox"/> AKC® REG. NO.		Enter number here	DATE OF BIRTH
<input type="checkbox"/> PAL NO.			PLACE OF BIRTH (list country)
<input type="checkbox"/> FOREIGN REG. NO. & COUNTRY			Do not print the above in the catalog

BREEDER**SIRE****DAM**

Exhibitor's Code _____

ACTUAL OWNER(S) [4] _____

(Please Print)

OWNER'S ADDRESS _____**CITY** _____**STATE** _____**ZIP + 4** _____**NAME OF OWNER'S AGENT**
(IF ANY) AT THE SHOW**CODE #** _____

I CERTIFY that I am the actual owner of the dog, or that I am the duly authorized agent of the actual owner whose name I have entered above. In consideration of the acceptance of this entry, I (we) agree to abide by the rules and regulations of the American Kennel Club in effect at the time of this event, and by any additional rules and regulations appearing in the premium list for this event, and further agree to be bound by the "Agreement" printed on the reverse side of this entry form. I (we) certify and represent that the dog entered is not a hazard to persons or other dogs. This entry is submitted for acceptance on the foregoing representation and Agreement. I (we) agree to conduct myself (ourselves) in accordance with all such Rules and Regulations (including all provisions applying to discipline) and to abide by any decisions made in accord with them.

SIGNATURE of owner or his agent
duly authorized to make this entry _____

Telephone () _____

Are you a new exhibitor? Yes No **Email address:** _____

(An acknowledgement or receipt of entry may be sent to this email address):

AGREEMENT

I (we) agree that the club holding this event has the right to refuse this entry for cause which the club shall deem sufficient. In consideration of the acceptance of this entry and of the holding of this event and of the opportunity to have the dog judged and to win prizes, ribbons, or trophies, I (we) agree to hold the AKC, the event-giving club, their members, directors, governors, officers, agents, superintendents or event secretary and the owner and/or lessor of the premises and any provider of services that are necessary to hold this event and any employees or volunteers of the aforementioned parties, and any AKC approved judge, judging at this event, harmless from any claim for loss or injury which may be alleged to have been caused directly or indirectly to any person or thing by the act of this dog while in or about the event premises or grounds or near any entrance thereto, and I (we) personally assume all responsibility and liability for any such claim; and I (we) further agree to hold the aforementioned parties harmless from any claim for loss, injury or damage to this dog.

Additionally, I (we) hereby assume the sole responsibility for and agree to indemnify, defend and save the aforementioned parties harmless from any and all loss and expense (including legal fees) by reason of the liability imposed by law upon any of the aforementioned parties for damage because of bodily injuries, including death at any time resulting therefrom, sustained by any person or persons, including myself (ourselves) or on account of damage to property, arising out of or in consequence of my (our) participation in this event, however such injuries, death or property damage may be caused, and whether or not the same may have been caused or may be alleged to have been caused by the negligence of the aforementioned parties or any of their employees, agents, or any other persons. **I (WE) AGREE THAT ANY CAUSE OF ACTION, CONTROVERSY OR CLAIM ARISING OUT OF OR RELATED TO THE ENTRY, EXHIBITION OR ATTENDANCE AT THE EVENT BETWEEN THE AKC AND THE EVENT-GIVING CLUB (UNLESS OTHERWISE STATED IN ITS PREMIUM LIST) AND MYSELF (OURSELVES) OR AS TO THE CONSTRUCTION, INTERPRETATION AND EFFECT OF THIS AGREEMENT SHALL BE SETTLED BY ARBITRATION PURSUANT TO THE APPLICABLE RULES OF THE AMERICAN ARBITRATION ASSOCIATION. HOWEVER, PRIOR TO ARBITRATION ALL APPLICABLE AKC BYLAWS, RULES, REGULATIONS AND PROCEDURES MUST FIRST BE FOLLOWED AS SET FORTH IN THE AKC CHARTER AND BYLAWS, RULES, REGULATIONS, PUBLISHED POLICIES AND GUIDELINES.**

INSTRUCTIONS

- (Variety) if you are entering a dog of breed in which there are varieties for show purposes, please designate the particular variety you are entering i.e., Cocker Spaniel (solid color black, ASCOB, parti-color). Beagles (not exceeding 13 in. over 13 in. but not exceeding 15 in.). Dachshunds (longhaired, smooth, wirehaired), Bull Terriers (colored, white), Manchester Terriers (standard, toy), Chihuahuas (smooth coat, long coat), English Toy Spaniels (King Charles and Ruby, Blenheim and Prince Charles), Poodles (toy, miniature, standard), Collies (rough, smooth),
 - The following categories of dogs may be entered and shown in Best of Breed competition; Dogs that are Champions of Record and dogs which, according to their owner's records, have completed the requirements for a championship, but whose championships are unconfirmed. The showing of unconfirmed Champions in Best of Breed competition is limited to a period of 90 days from the date of the show where the dog completed the requirements for a championship.
 - (Event Class) Consult the classification in this premium list. If the event class in which you are entering your dog is divided, then, in addition to designating the class, specify the particular division of the class in which you are entering your dog, i.e., age division, color division, weight division.
 - A dog must be entered in the name of the person who actually owned it at the time entries for an event closed. If a registered dog has been acquired by a new owner, it must be entered in the name of its new owner in any event for which entries closed after the date of acquirement, regardless of whether the new owner has received the registration certificate indicating that the dog is recorded in his name. State on entry form whether transfer application has been mailed to the A.K.C. (For complete rules refer to Chapter 11, Section 3).
 - Dogs entering mixed breed classes (eligible only in standalone Agility, Obedience, and Rally trials) should mark Breed as "MIXED BREED". Variety, Breeder, Sire, Dam information shall remain blank for mixed breed entrants.
-

JUNIOR SHOWMANSHIP. If this entry is for Jr Showmanship, please give the following information:

AKC JR HANDLER #

JR.'S DATE OF BIRTH

The above number **MUST** be included. Should you not have your Junior Handler number, this may be obtained from the American Kennel Club. Phone: (919) 816-3776.

By signing the entry form I (we) certify that the Junior Showman does not now, and will not at any time, act as an agent/handler for pay while continuing to compete in Junior Showmanship.

ADDRESS _____

CITY _____

STATE _____

ZIP + 4 _____

■ If Jr. Handler is not the owner of the dog identified on

the face of this form, what is the relationship of the Jr. Handler to the owner?
